



Online Cabinets Direct
3515 Cleburne Road Suite 201
Columbia, TN 38401
Office: 615-828-8377
Fax: 615-302-8214
E-mail: orders@onlinecabinetsdirect.com
URL: www.onlinecabinetsdirect.com

How To Assemble Cabinets

Getting Started:

1. Prepare A Flat Work Space 6-8 Foot In Diameter
2. Apply Protection Layer (Cloth Sheet, Cotton Blanket, Etc.) To Avoid Scratching Face Frame, Doors And Drawer Headers.
3. Open Cardboard Boxes
4. Group Cabinet Pieces For Each Cabinet
5. Identify And Organize All Parts (To Include But Not Limited To The Following)
 - 2 – ½” Plywood Side Panels
 - 1 – ½” Plywood Back Panel
 - 2 – ½” Plywood Hanging Rails
 - 1 – ½” Plywood Toe Kick Backer Panel 4 ½” Tall
 - 1 – ¾” Finished To Match Face Frame
 - 1 – ½” Plywood Top Panel (Wall & Tall Cabinets Only)
 - 1 – 1/2” Plywood Bottom Panel
 - 2 – ½” Plywood I-Beam Stretcher Panels
 1. Base Cabinet I-Beam Stretcher Panels 4” x 22 5/8”
 2. Vanity Cabinet I-Beam Stretcher Panel 4” x 19 5/8”
 - Drawer Slides (2 Per Drawer Box)
 1. Base Cabinet Drawer Slide 21”
 2. Vanity Cabinet Drawer Slide 18”
 - Door(s) Depending On Cabinet Size
 - Door Hinges
 - Drawer Header(s) Depending On Cabinet Size
 - 4 – 5/8” Solid Wood Dove Tail Drawer Box Panels
 - 1 – ¼” Plywood Drawer Box Bottom Panel

Tools Recommended:

- Brad Nail Gun or Corrugated Nail Gun
- Air Compressor
- C-Clamps
- Bar Clamps
- Square
- Tape Measure
- Pencil
- Wood Glue
- Rubber Mallet
- Hammer w/ Wood Block
- Drill W/ 1/8" & 5/32" Drill Bits
- #2 Phillips Screw Driver
- #8 Wood Screws
- Cotton Wiping Cloth (To Clean Excess Glue)
- Level
- 5/8" 18 Gauge Galvanized Brad Nails For Attaching Face Frame To Side Panels
- 3/4" 18 Gauge Galvanized Brad Nails For Attaching Plywood Side Panels To Top Panel (Wall Cabinets & Tall Cabinets Only), Bottom Panel, Back Panel, I-Beam Stretcher Panels (Base Cabinets & Vanity Cabinets Only) and Toe Kick Backer Panel.
- We Recommend Cabinets With Exposed Sides (Sides That Are Seen After Installation) First, This Will Ensure You Will Have Replacement Parts From Other Cabinets If You Damage The Side Panels When Nailing or During Assembly.

Wall Cabinet Assembly Instructions:

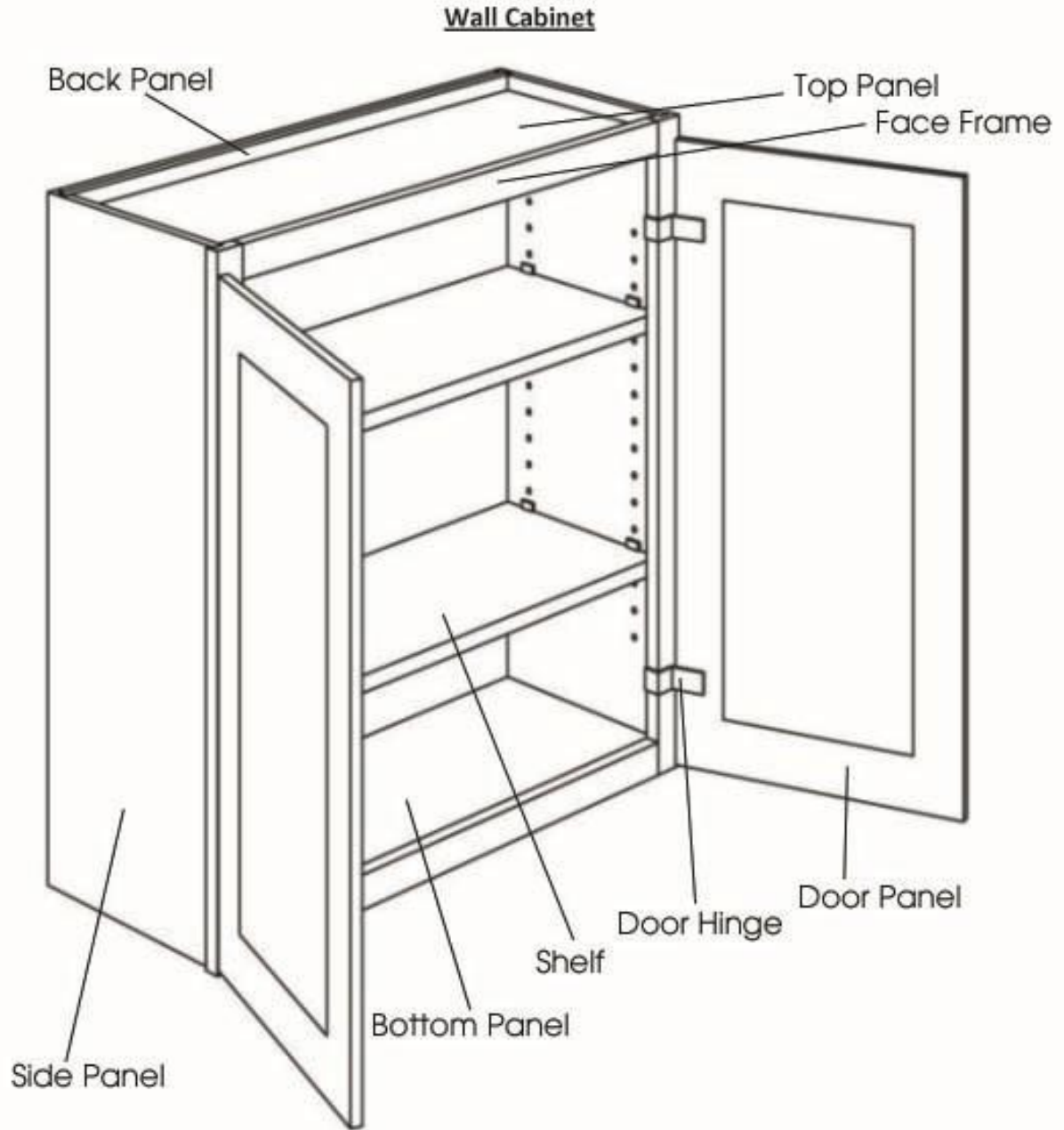

Unpack Cardboard Cabinet Box:



Figure 1

Apply Wood Glue In The Dadoe Joints On The Face Frame

Assembly:

Lay face frame face down on protected surface
Apply glue in left and right dado joint



Figure 2

Place side panel in dado joint of face frame with joinery to inside of box
Align top of side panel with top of face frame so that it is flush.
Make sure side panel is fully compressed in dado joint. Use bar clamp if any bow appears in face frame.
Nail through side panel into face frame holding nail gun at 45° angle. Nail left and right panels; one nail about every 4".

Attach The Side Panels To The Face Frame With 5/8" or 3/4" Brad Nails At A 45 Degree Angle



Figure 3

Attach The Top Panel To The Face Frame

Place top and bottom into face frame with glue in dado joint. Nail in place
Apply glue to dado joint in side panel and apply glue to top and bottom panels.



Attach The Bottom Panel To The Face Frame



Figure 5

Apply Wood Glue In All Dadoe Joints To Attach The Back Panel

Installation of top and back panel:



Figure 6

Place The Back Panel In The Side Panel, Bottom Panel & The Top Panel Dadoe Joints. Attach The Panel With 3/4" Brad Nails



Figure 7

Apply The Back Panel Hanging Rails



Figure 12

Base cabinet notes:

Large hanging rail goes towards top of Cabinet

Small hanging rail goes to bottom of Cabinet

Toe goes on last during case assembly before doors. Apply the same way as side panel with 45 degree nail through toe into frame.



Figure 11

Attach The Doors To The Face Frame

Door hung to inside of frame



Figure 23

Screw in Door Hinges:



Figure 22

Base Cabinet Assembly Instructions

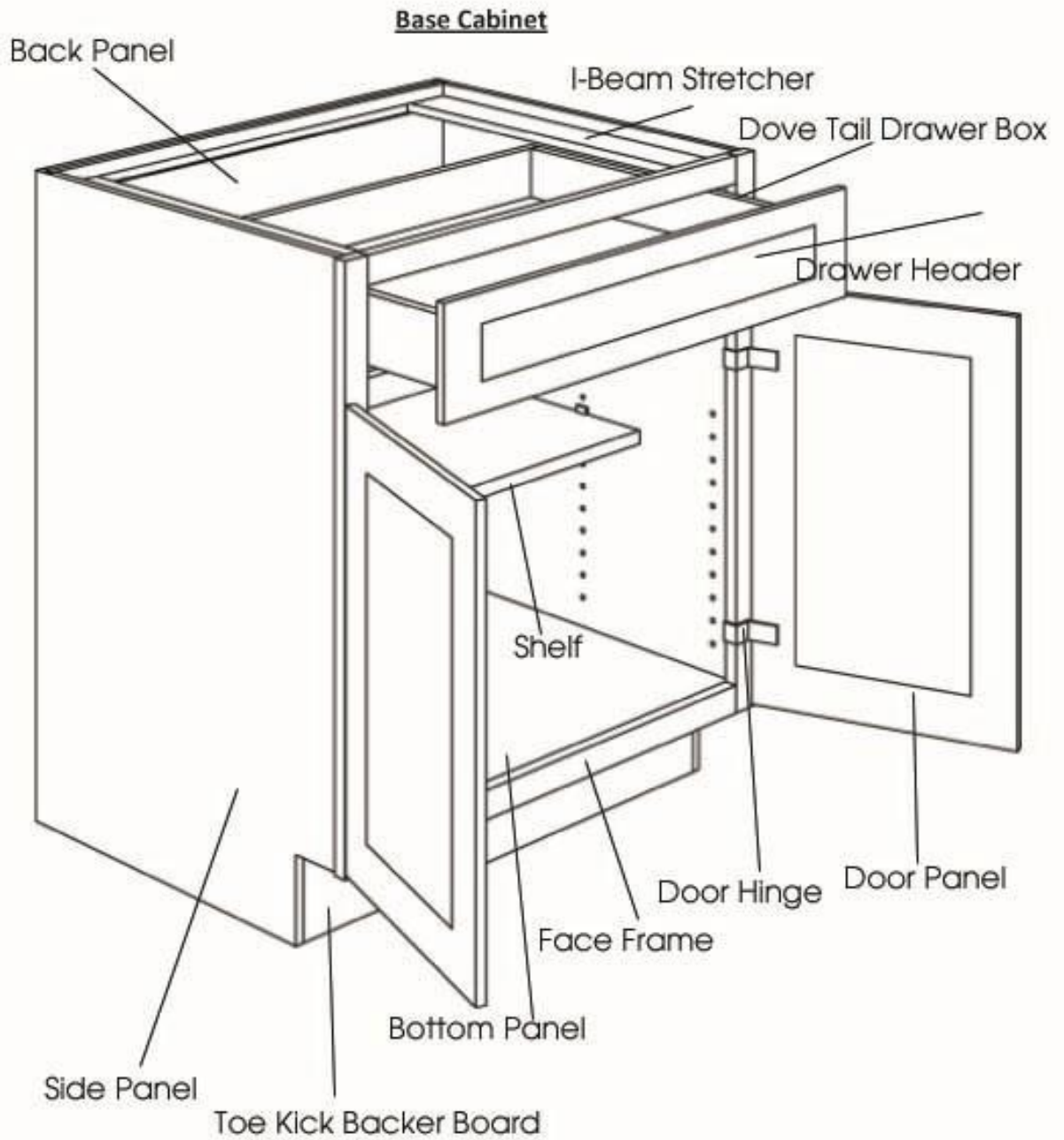

Apply Wood Glue In The Dadoe Joints On The Face Frame

Assembly:

Lay face frame face down on protected surface

Apply glue in left and right dado joint



Figure 2

Place side panel in dado joint of face frame with joinery to inside of box

Align top of side panel with top of face frame so that it is flush.

Make sure side panel is fully compressed in dado joint. Use bar clamp if any bow appears in face frame.

Nail through side panel into face frame holding nail gun at 45° angle. Nail left and right panels; one nail about every 4".

Attach The Side Panels To The Face Frame With 5/8" or 3/4" Brad Nails Shot At A 45 Degree Angle



Figure 3

Attach The Bottom Panel To The Face Frame With Brad Nails



Figure 5

Attach The I-Beam Stretcher Panels To Side Panels And Back Panel With Brad Nails

Base Cabinet Notes:

Top Stretcher boards are used in place of a top panel. Attach to left side panel first. Sq with face frame, then attach to face frame.

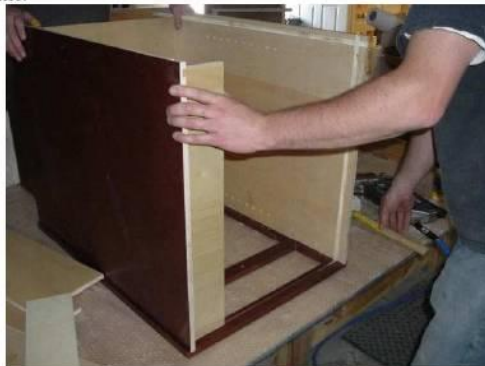

Figure 8



Figure 9

Attach The Back Panel To The Side, I-Beam Stretchers & Bottom Panel With Brad Nails. Make Sure To Add Wood Glue To All Dadoe Joints.

Base Cabinet:



Figure 10

Nail left side first. Using square to align bottom, nail bottom. Align top with square, nail top. Nail right side panel. Nail about every 4" when securing sides to back, bottom to top.

Attach 1/2" Plywood Hanging Rail Supports To Back Panel



Figure 12

Base cabinet notes:

Large hanging rail goes towards top of Cabinet

Small hanging rail goes to bottom of Cabinet

Toe goes on last during case assembly before doors. Apply the same way as side panel with 45 degree nail through toe into frame.

Assemble The Drawer Box Material, Use Wood Glue In Dove Tail Joints And Apply Brad Nails

Drawer Box:

Identifying Drawer Box Parts:

- Groove goes towards bottom
- Piece with holes is drawer box front
- Back has notches for drawer glides

Start with back. Two ends go into back. Hammer together/glue at joints:



Figure 13

Insert drawer bottom (Does not need to be glued) then attach front:



Figure 14

Brush glue onto all dovetail joints. One nail into each dovetail joint to ensure it holds together while glue dries.

Attach The Drawer Glide Receiver Clips To The Drawer Box Bottom

Drawer Glide Receivers:

- Mount on the front of the drawer box on bottom
- Longest point goes to inside
- 3 screws (2 on front / 1 on side)
- Plastic tab to adjust alignment of drawer head/drawer box



Figure 15

The L bracket/drawer glide bottom goes at same height as top of intermediate rail. Runner should be parallel to side & level from front to back. Drawer glides mount to inside of face frame.
(Refer to Figure 16-18)

Attach The Drawer Glide Support Brackets To The Back Panel



Figure 16

Attach The Drawer Glide To The Drawer Glide Support Bracket



Figure 17

Attach The Drawer Glide To The Face Frame



Figure 18

Attaching The Drawer Glide To The Drawer Box

Extend runner completely then place drawer box on runners



Figure 19

Use a $\frac{3}{4}$ " slat of wood or a straight edge to line up drawer head to front of box.
(Refer to Figure 20-21)

Attach The Doors To The Face Frame



Figure 24



Figure 26

Finished Product:



Figure 25